

# FEATHER & BLACK

## SIENNA BEAU SCROLL BED

### ASSEMBLY GUIDE



# WELCOME TO THE FEATHER & BLACK COMMUNITY.

Since 2004, we've been dedicated to creating beautifully crafted bedroom furniture that's made to last. We believe your home is a reflection of you, that's why every piece we create is thoughtfully designed and carefully finished.

We hope your new addition feels right at home. If you need anything at all, our team is here to help – simply call 01494 415 399 (option 2), email [customerservices@featherandblack.com](mailto:customerservices@featherandblack.com), or chat to us live at [featherandblack.com](https://featherandblack.com).

We love seeing our designs styled in real homes – so if you're happy to share, tag us on Instagram @featherandblack and use #featherandblack.

From our home to yours, thank you for choosing furniture that's made to be lived in and loved for life.

## THE FEATHER & BLACK TEAM

PLEASE RETAIN THESE ASSEMBLY INSTRUCTIONS FOR FUTURE USE

# FEATHER & BLACK

## SIENNA BEAU SCROLL BED

### BEFORE YOU START

Thank you for purchasing this Sienna Beau Scroll Bed.

Please read these instructions fully prior to assembly to familiarise yourself with the various stages of construction. Carefully open all packs supplied and check the contents against the parts and fittings check list.

Do not destroy any of the packaging until you are certain that you have all the necessary parts for the assembly.

This item is heavy once assembled. Please try to assemble the item as close as possible to the point of use. Take care when moving the item to avoid personal injury or damage to the product and always lift rather than drag.

There are small components used in the construction of this furniture as well as plastic packaging, these should be kept away from young children whilst assembling.

#### PRODUCT SAFETY

All assembly fastenings should always be tightened properly, and care should be taken to ensure that no fittings are loose.

Periodically check and ensure that all components are in their proper position, free from damage, and that all connectors are tight.

Please note depending on the lighting, positioning and surroundings of your room, the shade of the colour can sometimes appear slightly different. Over a period of time the colour might lighten or fade slightly due to light exposure.

#### PRODUCT CARE

To clean, slightly moisten cloth with water and wipe surfaces. A damp cloth holds dust and cloth. Do not use abrasives or cleaning products which may contain ammonia or solvents.

#### NUMBER OF PEOPLE REQUIRED TO ASSEMBLE

Two people to assemble the product and two people to lift in to position.

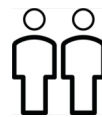

#### TIME TO ASSEMBLE



(30 minutes)

#### NECESSARY TOOLS

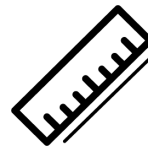

Tape measure

# FEATHER & BLACK

## SIENNA BEAU SCROLL BED

### COMPONENTS SUPPLIED (NOT ACTUAL SIZE)

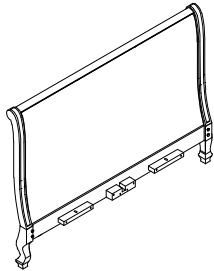

Ref: A - Headboard  
Quantity: 1pc  
Box Number: 1

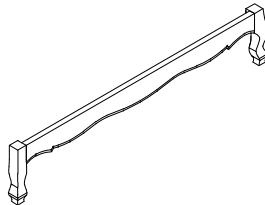

Ref: B - Footboard  
Quantity: 1pc  
Box Number: 1

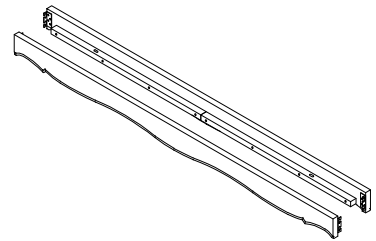

Ref: C - Side Rails  
Quantity: 2pcs  
Box Number: 2

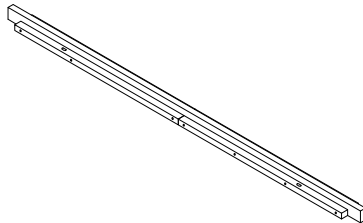

Ref: D - Center Support  
Quantity: 1pc  
Box Number: 2

### FIXTURES AND FITTINGS SUPPLIED (NOT ACTUAL SIZE)

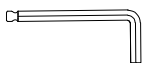

Ref: E - Allen key  
Dimension (mm): M4x110  
Quantity: 2pcs  
Box Number: 1



Ref: F - Sleeve Nut  
Dimension (mm): M6x20  
Quantity: 12pcs  
Box Number: 1



Ref: G - Flat washer  
Dimension (mm): M6 (Ø16)  
Quantity: 12pcs  
Box Number: 1

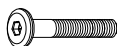

Ref: H - Bolt  
Dimension (mm): M6x55  
Quantity: 12pcs  
Box Number: 1

0cm 1 2 3 4 5 6 7 8 9 10 11 12 13 14 15 16 17 18

# FEATHER & BLACK

## SIENNA BEAU SCROLL BED

1.

Loosen pre-installed bolts and attach siderails (C) to headboard (A) and footboard (B) by using allen key (E)

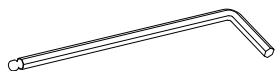
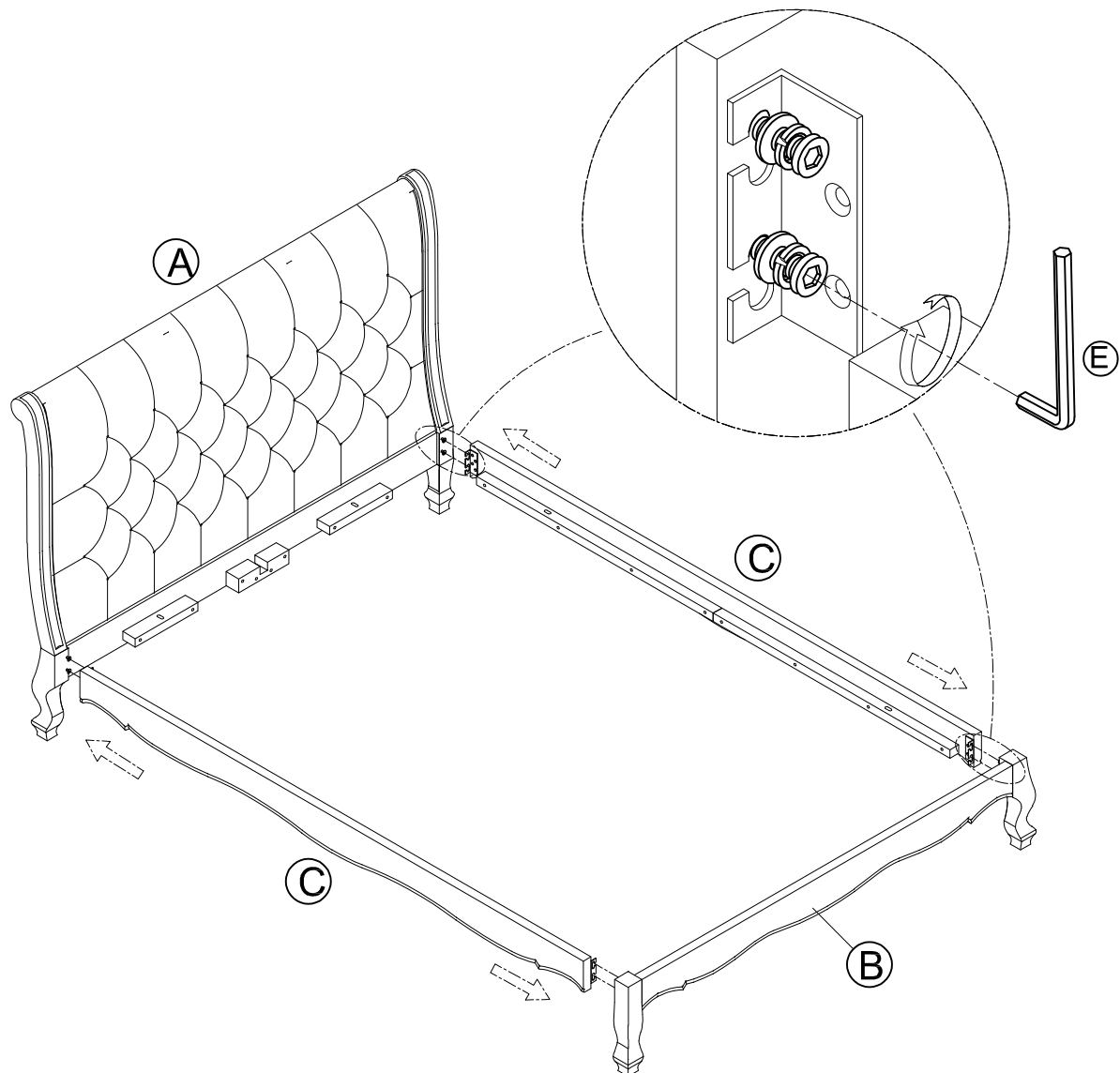

E: Allen key M4x110 (mm)

# FEATHER & BLACK

## SIENNA BEAU SCROLL BED

2.

Attach central rail to footboard (B) and headboard (A).

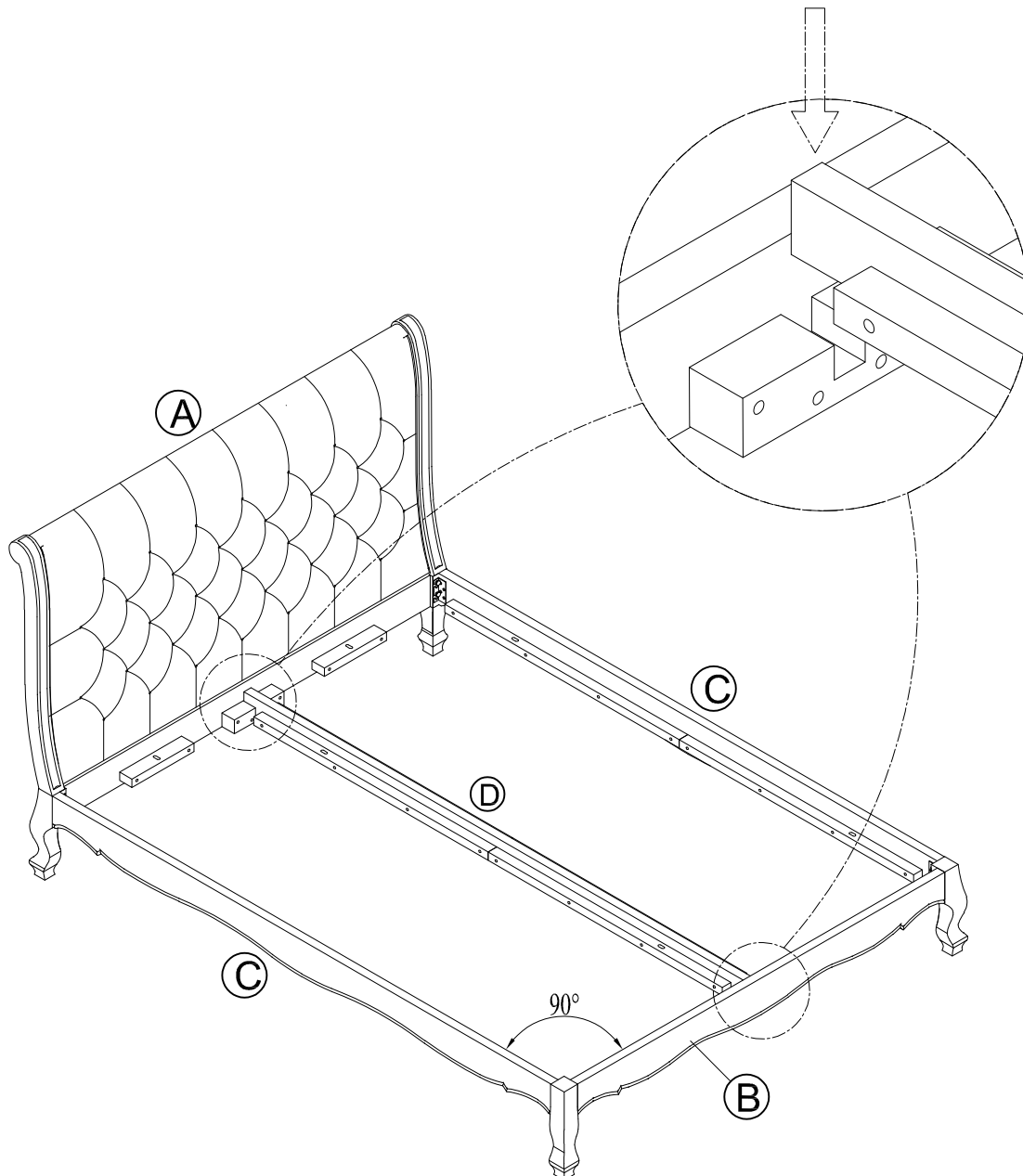

# FEATHER & BLACK

## SIENNA BEAU SCROLL BED

Product size: Double : 30mm H x 1920mm W x 667mm D =2pcs  
King : 30mm H x 2020mm W x 742mm D =2pcs  
Super King : 30mm H x 2020mm W x 892mm D =2pcs

Sprung slat system (Supplied Separately)

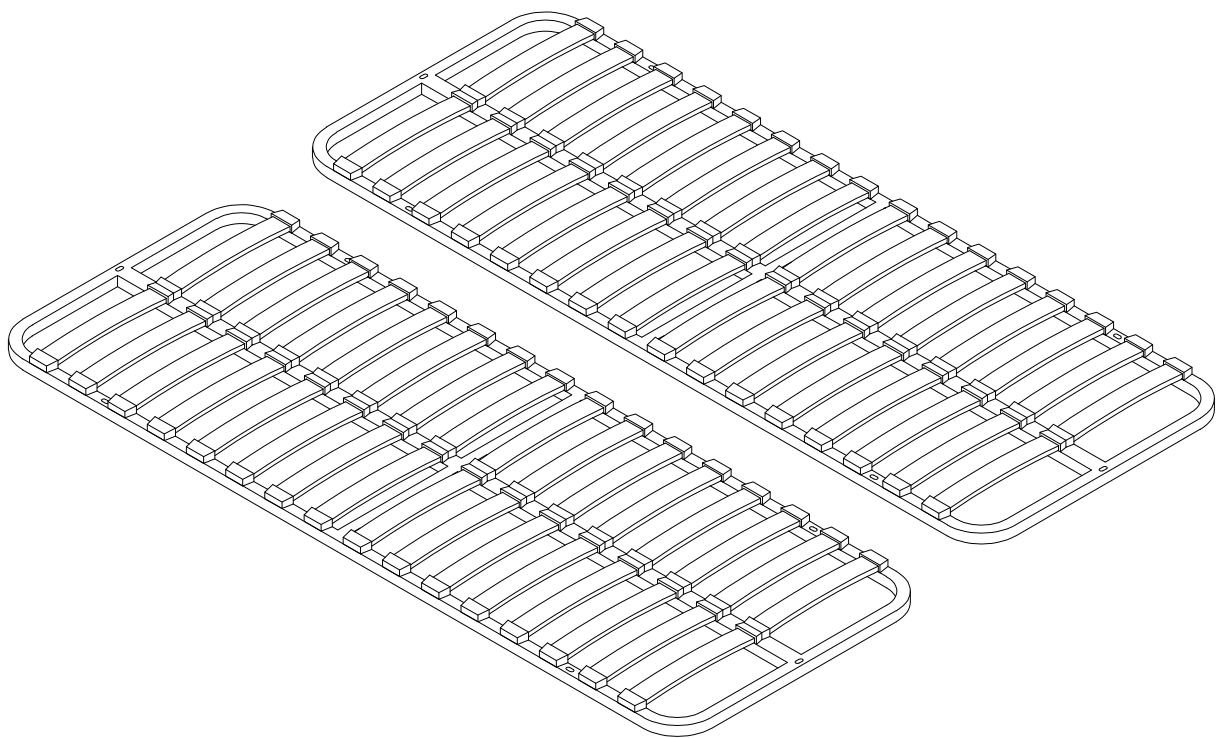

# FEATHER & BLACK

## SIENNA BEAU SCROLL BED

3.

Position the frame evenly onto the slat supports on each rail. Align the frame with fixing holes at each end then secure it using 12 sets of bolt (H), flatwasher (G), sleeve nut (F) and allen key (E).

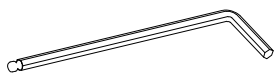
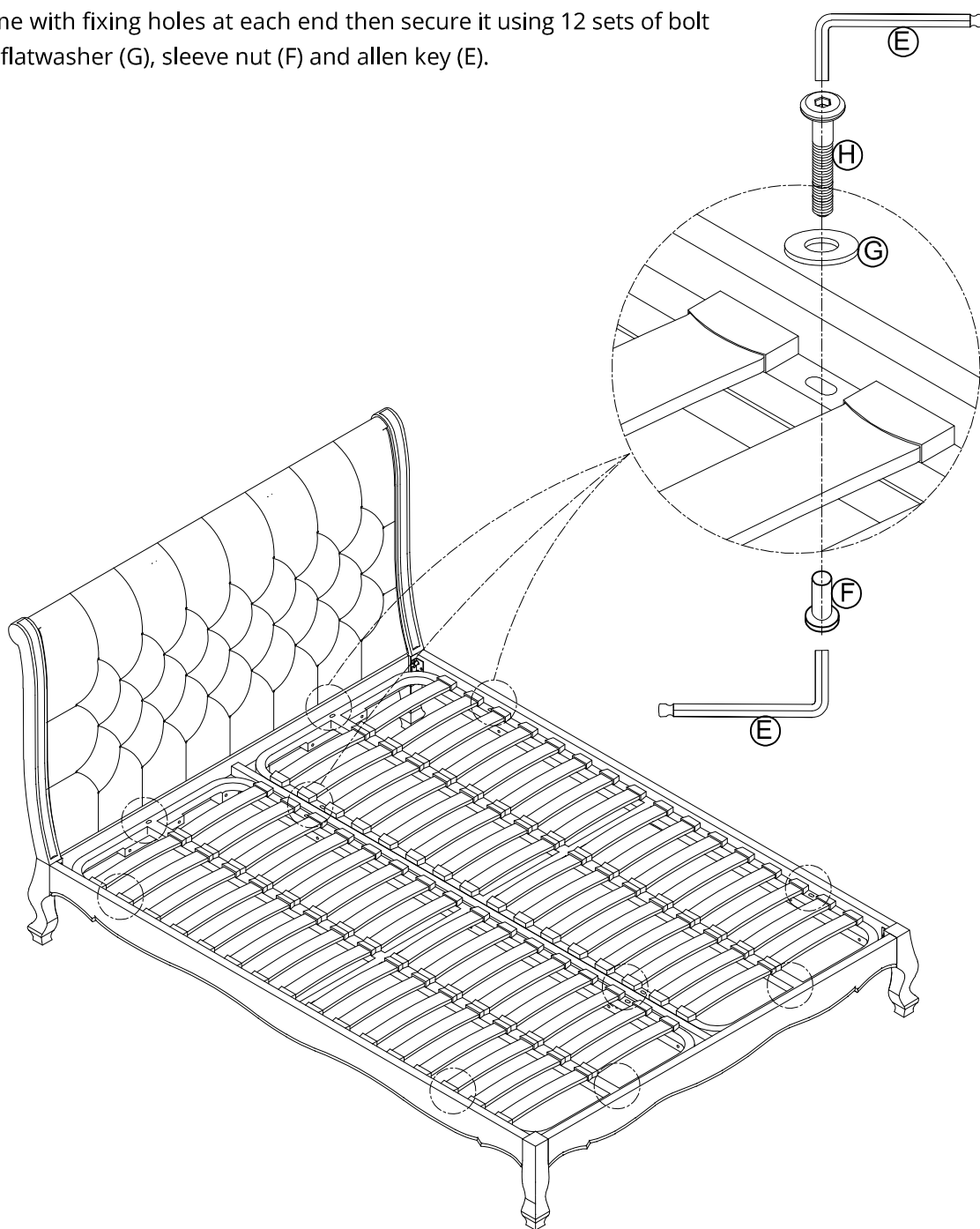

E: Allen key M4x110 (mm)



F: Sleeve Nut M6x20 (mm)



G: Flat washer M6 (Ø16mm)

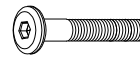

H: Bolt M6x55 (mm)



# FEATHER & BLACK

[featherandblack.com](http://featherandblack.com)